

19" Wall Mount Open Frame

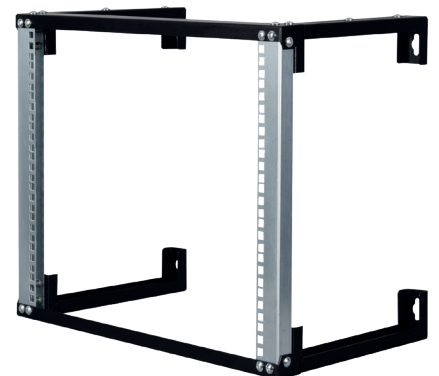

19" Wall Mount Open Frame

Load Capacity: 30 kgs.

U Height: 7U, 9U, 12U, 16U and 21U

Standards and Compliances:



ISO 9001
Quality Management System

EN 61587-1
Mechanical Structures for
Electronic Equipment

IEC 297-1, 19" Mounting
IEC 297-2 Overall Cabinet Dimensions

EN/IEC 62262- IK10 Mechanical
Impact Resistance



CE conform to
EN 60950-1
Information Technology
Equipment, Safety,
Part-1: General Requirement

EN IEC 62368-1 Audio/Video,
Information and Communication
Technology Equipment
Part 1: Safety requirements



UL listed to
UL 2416, Outline of Investigation for
Audio/Video, Information and
Communication Technology Equipment
Cabinet, Enclosure and Rack
Systems; UL 60950-1 and CSA
C22.2 NO. 60950-1-07, Information
Technology Equipment Safety
Part 1: General Requirements



Environment Friendly;
ISO 14001 Environmental
Management System
RoHS compliancy
%100 Recyclable Material

Standard Color:

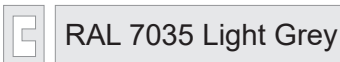

Optional Color:

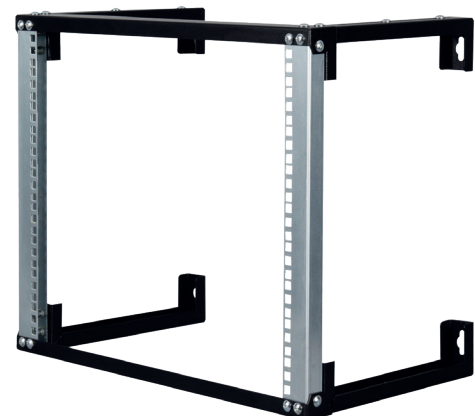
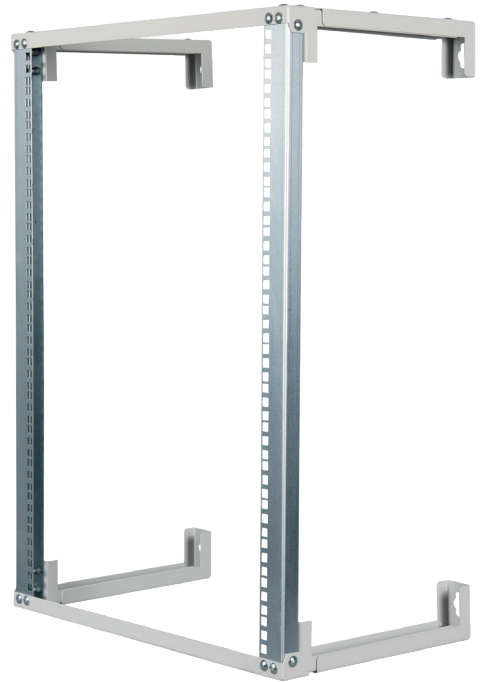

19" Wall Mount Open Frame

Lande Wall Mount Open Frame is used for mounting 19" devices such as; patch panels, adapters and switches. The Open Frame provides adjustable depth with sliding rail system.

- LANDE Wall Mount Open Frames are used for cabling and mounting 19" equipment to the wall or any straight surface which allows you a space-saving solution for your office.

- The product can fix to a wall or ceiling by rear sliding rails, allowing horizontal or vertical fixation.

- The parts are produced from multi-bended thick material, for strength and rigidity which allows the equipment to be installed securely and safely.

- Compatible to EIA310-D Standard, with square holes in U pattern to provide M6 cage nuts.

- Compatible to TS 914 / EN ISO 1461 standard; produced from 1,50 mm thick & DC01-6112 quality raw material sheet.

- Front frame and sliding rail parts are fixed to each other by multi screws, and product is a modular structure for easy, efficient shipping.

- Mounting profiles are electro-galvanised zinc coated, other component parts are painted with electrostatic powder paint after surface treatment with Nano-zirconium Henkel Bonderite technology.

- 500 hrs of salt spray test resistance against corrosion.

- Loading capacity up to 30 kgs.



19" Wall Mount Open Frame

Technical Drawings

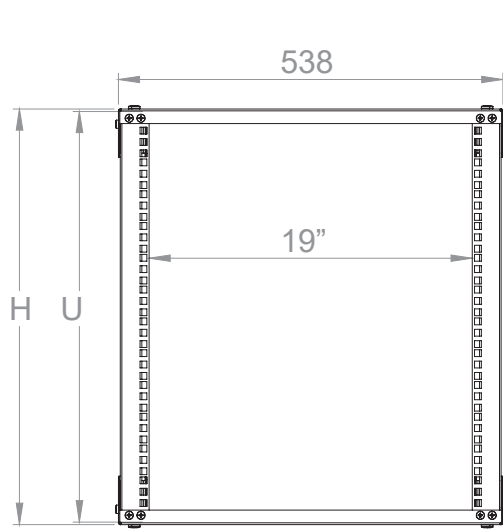

Front view

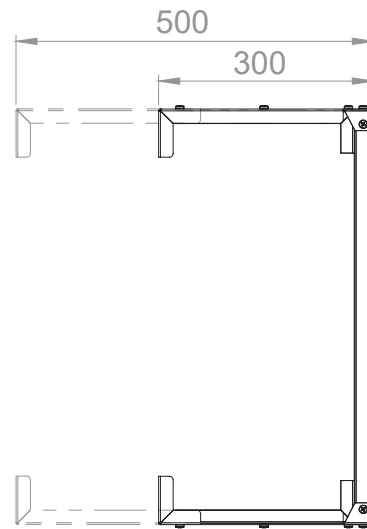

Side view

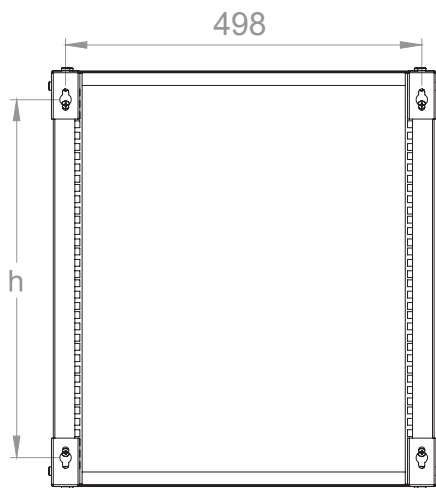

Rear view

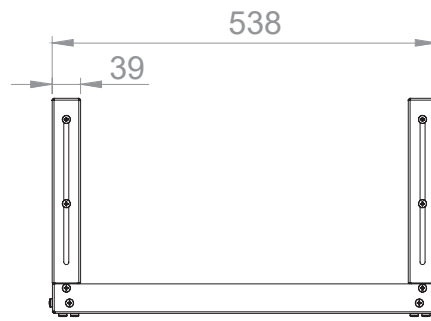

Top view

U	H	h
7U	359 mm	279 mm
9U	448 mm	368 mm
12U	581 mm	501 mm
16U	759 mm	679 mm
21U	981 mm	901 mm

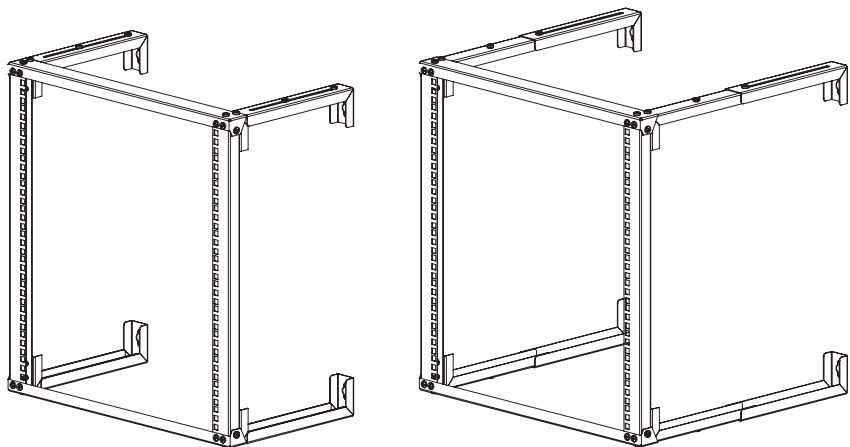

Isometric view

19" Wall Mount Open Frame

Technical Drawings

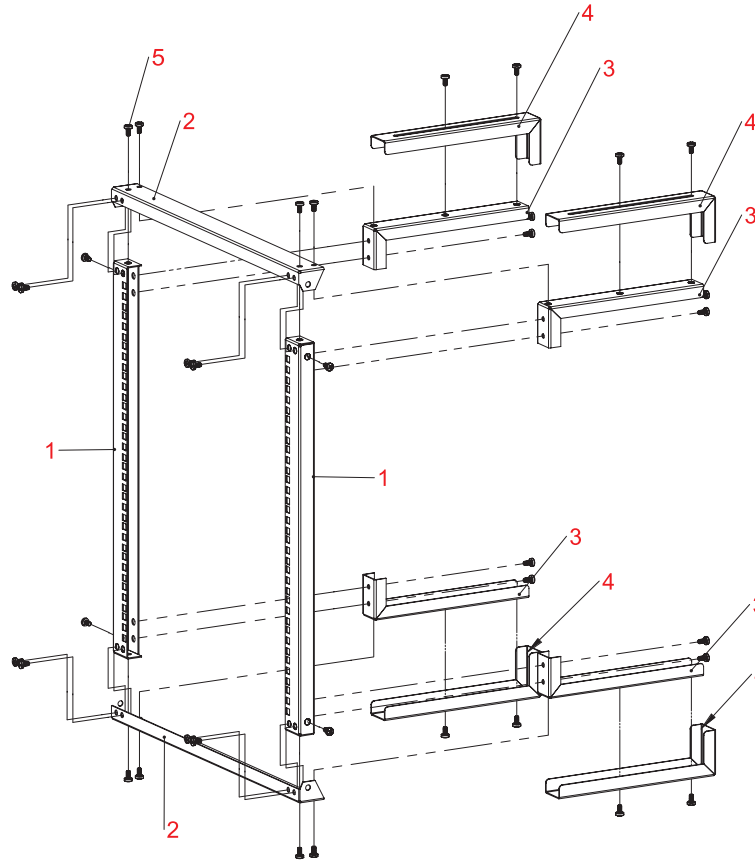

Part Info:

Material Definition and Properties, Thicknesses and Shipment Configuration

Part Number	Part Definition	Material Thickness	Material Definition & Properties	Surface Treatment	Shipment Configuration
1	Mounting profile part	1,50 mm.	DIN EN 10130 - 99 EREGLI DC-01 6112 CRS	Electro-galvanise coating	2 ea.
2	Top & bottom frame part	1,50 mm.	DIN EN 10130 - 99 EREGLI DC-01 6112 CRS	Electrostatic powder paint	2 ea.
3	Internal wall support part	1,50 mm.	DIN EN 10130 - 99 EREGLI DC-01 6112 CRS	Electrostatic powder paint	4 ea.
4	External wall support part	1,50 mm.	DIN EN 10130 - 99 EREGLI DC-01 6112 CRS	Electrostatic powder paint	4 ea.
5	M6x10 screw	-	M6X10 pan head cross recess screw-DIN 967	Electro-galvanise coating	36 ea.

Logistics Data:

19" Wall Mount Open Frame

Product Number	Product Description	Size WXDxH mm	h			Width Overall mm	Width Rail to Rail	Depth Overall mm	Depth Shipping Conf. Rail to Rail mm	QTY IN PACKAGE	PACKING DIMENSIONS WXDxH mm	Standard NET Weight of Product kgs	Gross Weight of Product kgs	QTY IN PALLET	PALLET DIMENSIONS WXDxH mm	Pallet Weight kgs
			h Size in U	h in mm	H mm											
LN-WF07U1930-CC	07U Open Frame Wall Mount Cabinet (Depth Adjustable)	540x300x362	7U	355	362	540	19"	300	-	1	605x120x75	3,8	3,9	75	680x680x1280	302
LN-WF09U1930-CC	09U Open Frame Wall Mount Cabinet (Depth Adjustable)	540x300x452	9U	445	452	540	19"	300	-	1	605x120x75	3,9	4	75	680x680x1280	310
LN-WF12U1930-CC	12U Open Frame Wall Mount Cabinet (Depth Adjustable)	540x300x585	12U	578	585	540	19"	300	-	1	605x120x75	4,2	4,3	75	680x680x1280	332
LN-WF16U1930-CC	16U Open Frame Wall Mount Cabinet (Depth Adjustable)	540x300x763	16U	756	763	540	19"	300	-	1	1010x120x75	4,7	4,8	75	680x1050x1280	365
LN-WF21U1930-CC	21U Open Frame Wall Mount Cabinet (Depth Adjustable)	540x300x985	21U	978	985	540	19"	300	-	1	1010x120x75	5,1	5,2	75	680x1050x1280	405

*CC= Color codification, replace CC with BL for Black RAL 9005 Color and replace CC with LG for Light Grey RAL 7035 Color. Standard color is Light Grey RAL 7035 if not defined LG coded version will be shipped.

19" Wall Mount Open Frame

Threaded for M5 Screw

Load Capacity: 30 kgs.

U Height: 7U, 9U, 12U, 16U and 21U

Standards and Compliances:



ISO 9001
Quality Management System

EN 61587-1
Mechanical Structures for
Electronic Equipment

IEC 297-1, 19" Mounting
IEC 297-2 Overall Cabinet Dimensions

EN/IEC 62262- IK10 Mechanical
Impact Resistance



CE conform to
EN 60950-1
Information Technology
Equipment, Safety,
Part-1: General Requirement

EN IEC 62368-1 Audio/Video,
Information and Communication
Technology Equipment
Part 1: Safety requirements



UL listed to
UL 2416, Outline of Investigation for
Audio/Video, Information and
Communication Technology Equipment
Cabinet, Enclosure and Rack
Systems; UL 60950-1 and CSA
C22.2 NO. 60950-1-07, Information
Technology Equipment Safety
Part 1: General Requirements



Environment Friendly;
ISO 14001 Environmental
Management System
RoHS compliancy
%100 Recyclable Material

Standard Color:



RAL 7035 Light Grey

Optional Color:



RAL 9005 Black



19" Wall Mount Open Frame

Threaded for M5 Screw

Lande Wall Mount Open Frame is used for mounting 19" devices such as; patch panels, adapters and switches. The Open Frame provides to adjustable depth with sliding rail system.

- LANDE Wall Mount Open Frames are used for cabling and mounting 19" equipment to the wall or any straight surface which allows you a space-saving solution for your office.

- The product can fix to a wall or ceiling by rear sliding rails, allowing horizontal or vertical fixation.

- The parts are produced from multi-bended thick material, for strength and rigidity which allows the equipment to be installed securely and safely.

- Compatible to EIA310-D Standard, with square holes in U pattern to provide M6 cage nuts.

- Compatible to TS 914 / EN ISO 1461 standard; produced from 1,50 mm thick & DC01-6112 quality raw material sheet.

- Front frame and sliding rail parts are fixed to each other by multi screws, and product is a modular structure for easy, efficient shipping.

- Mounting profiles are electro-galvanised zinc coated, other component parts are painted with electrostatic powder paint after surface treatment with Nano-zirconium Henkel Bonderite technology.

- 19" rails are threaded for M5 screws, therefore no need of using M6 caged nuts, cup washer and screw set anymore, just M5 screws are enough, which gives quick assembly operations at site.

- 500 hrs of salt spray test resistance against corrosion.

- Loading capacity up to 30 kgs.



19" Wall Mount Open Frame

Threaded for M5 Screw - Technical Drawings

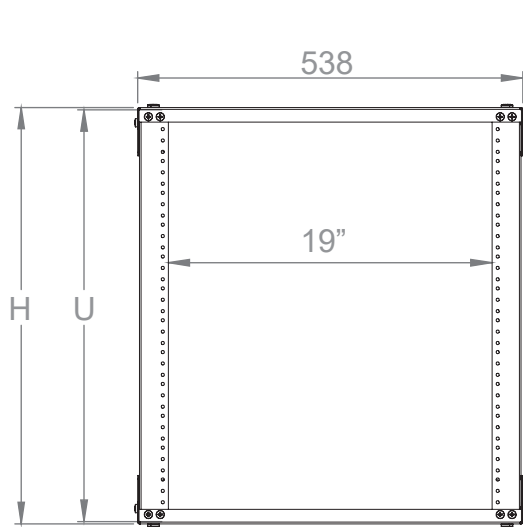

Front view

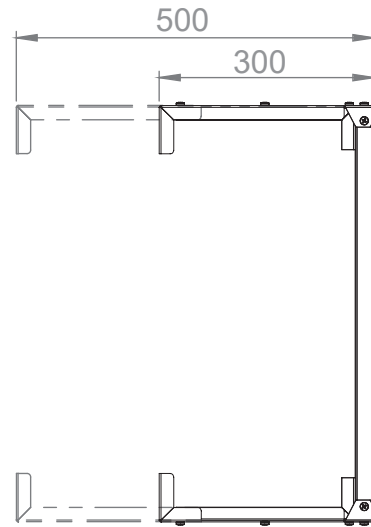

Side view

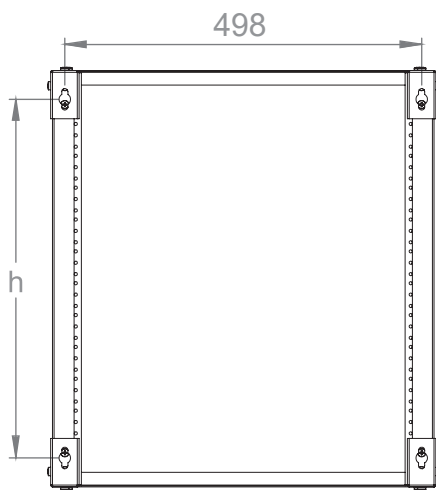

Rear view

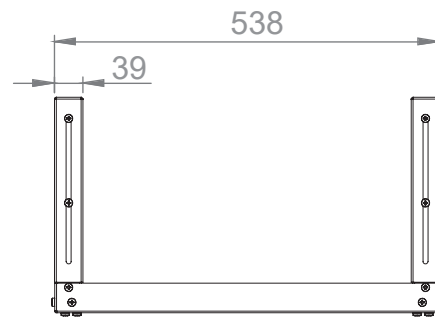

Top view

U	H	h
7U	359 mm	279 mm
9U	448 mm	368 mm
12U	581 mm	501 mm
16U	759 mm	679 mm
21U	981 mm	901 mm

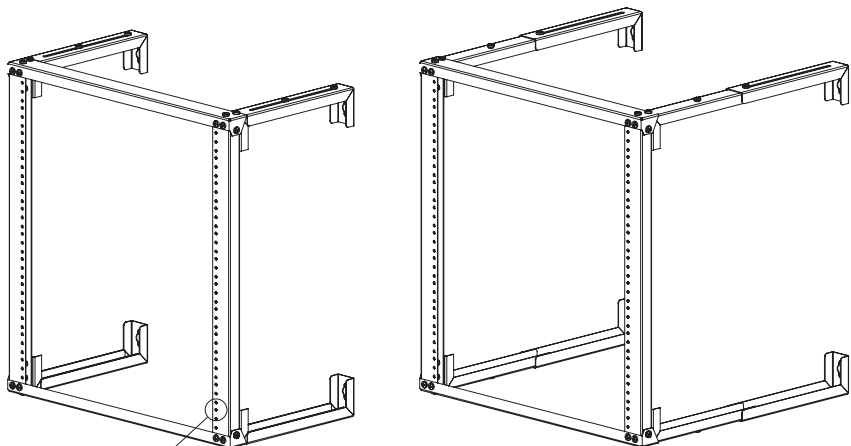

Isometric view

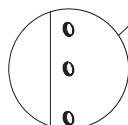

19" Wall Mount Open Frame

Threaded for M5 Screw - Technical Drawings

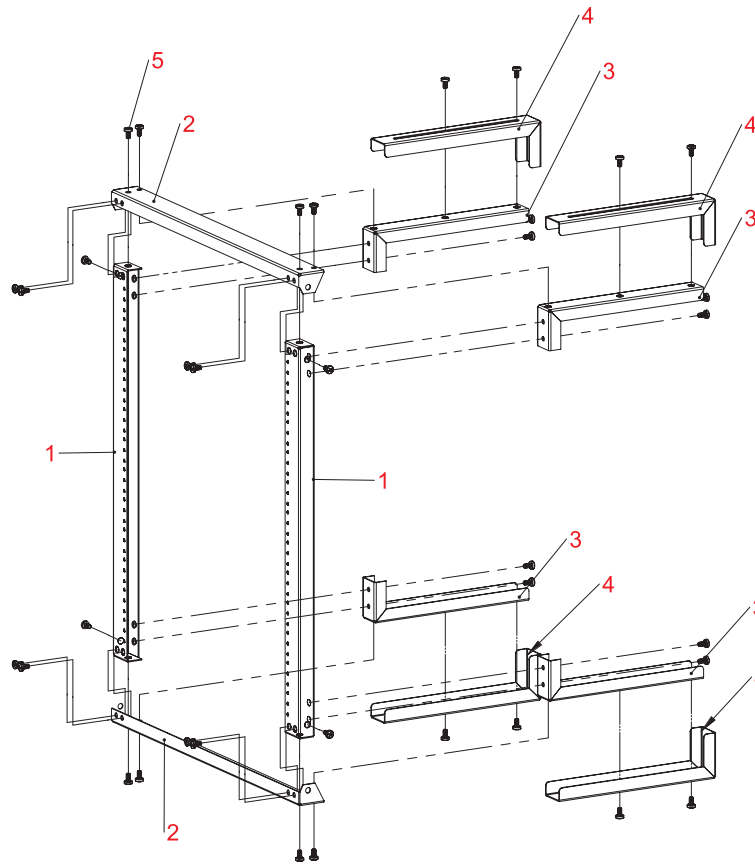

Part Info:

Material Definition and Properties, Thicknesses and Shipment Configuration

Part Number	Part Definition	Material Thickness	Material Definition & Properties	Surface Treatment	Shipment Configuration
1	Mounting profile part	1,50 mm.	DIN EN 10130 - 99 EREGLI DC-01 6112 CRS	Electro-galvanise coating	2 ea.
2	Top & bottom frame part	1,50 mm.	DIN EN 10130 - 99 EREGLI DC-01 6112 CRS	Electrostatic powder paint	2 ea.
3	Internal wall support part	1,50 mm.	DIN EN 10130 - 99 EREGLI DC-01 6112 CRS	Electrostatic powder paint	4 ea.
4	External wall support part	1,50 mm.	DIN EN 10130 - 99 EREGLI DC-01 6112 CRS	Electrostatic powder paint	4 ea.
5	M6x10 screw	-	M6X10 pan head cross recess screw-DIN 967	Electro-galvanise coating	36 ea.

Logistics Data:

19" Wall Mount Open Frame - Threaded for M5 Screw

Product Number**	Product Description	Size WXDxH mm	h Size in U	h in mm	H mm	Width Overall mm	Width Rail to Rail	Depth Overall mm	Depth Shipping Conf. Rail to Rail mm	QTY IN PACKAGE	PACKING DIMENSIONS WXDxH mm	Standard NET Weight of Product kgs	Gross Weight of Product kgs	QTY IN PALLET	PALLET DIMENSIONS WXDxH mm	Pallet Weight kgs
LN-WF07U1930-CC-TRR	07U Open Frame Wall Mount Cabinet (Depth Adjustable) Threaded for M5 Screw	540x300x362	7U	355	362	540	19"	300	-	1	605x120x75	3,8	3,9	75	680x680x1280	302
LN-WF09U1930-CC-TRR	09U Open Frame Wall Mount Cabinet (Depth Adjustable) Threaded for M5 Screw	540x300x452	9U	445	452	540	19"	300	-	1	605x120x75	3,9	4	75	680x680x1280	310
LN-WF12U1930-CC-TRR	12U Open Frame Wall Mount Cabinet (Depth Adjustable) Threaded for M5 Screw	540x300x585	12U	578	585	540	19"	300	-	1	605x120x75	4,2	4,3	75	680x680x1280	332
LN-WF16U1930-CC-TRR	16U Open Frame Wall Mount Cabinet (Depth Adjustable) Threaded for M5 Screw	540x300x763	16U	756	763	540	19"	300	-	1	1010x120x75	4,7	4,8	75	680x1050x1280	365
LN-WF21U1930-CC-TRR	21U Open Frame Wall Mount Cabinet (Depth Adjustable) Threaded for M5 Screw	540x300x985	21U	978	985	540	19"	300	-	1	1010x120x75	5,1	5,2	75	680x1050x1280	405

*CC= Color codification, replace CC with BL for Black RAL 9005 Color and replace CC with LG for Light Grey RAL 7035 Color.

Standard color is Light Grey RAL 7035 if not defined LG coded version will be shipped.

**TRR: Means the 19" rails are threaded rack rails for M5 screw, no need of M6 cage nuts anymore.



CONTACT DETAILS

Headquarters

Address:

Merve Mah. Gazi Cad. No: 17 **Phone:** +90 216 312 26 53 pbx
Sancaktepe - İstanbul / TURKEY **Fax** : +90 216 312 09 09

Factory

Address:

20. Cadde No: 14 Eskişehir **Phone:** +90 222 236 24 66 pbx
Organize San. Bölge. 26110 **Fax** : +90 222 236 13 53
Eskişehir / TURKEY

www.lande.com.tr | sales@lande.com.tr

